

# Heatmaster Popular Parasol Heater

User Instructions

U3-R20



---

## Technical Information

Power supply: 220 - 240V ~ 50Hz

Power rating: 900/1800W

Ingress protection: IPX3

Element type: Halogen

Life of lamp: Approximate maximum 5000 hours

Dimensions: H19cm x W45cm x D45cm

Net weight: 3.3kg



---

These instructions form part of this appliance. Please be sure to read them before use and keep for future reference. This product is for domestic use only and should not be used commercially or for contract purposes.

Produced in PRC for La Hacienda Ltd  
Hangar 27, Site C, Aston Down Airfield, Nr Stroud, Glos, GL6 8HR, UK  
[www.lahacienda.co.uk](http://www.lahacienda.co.uk)

## Care and safe use guidelines

### SAFETY INFORMATION

- Product labels, warnings and rating plates affixed with adhesive or other permanent means must never be removed; doing so will invalidate the product's regulatory compliance and its warranty.
- The integral plug(s) of this appliance must not be cut off or modified for any purpose including: extending the cable length, wiring directly into an electrical spur, or modification of any type. Doing so may cause electrical safety or fire hazards and thereby invalidate the product warranty.
- Caution - some parts of this appliance can become very hot and cause burns. Particular attention must be given where children and vulnerable people are present.
- Do not use this heater in the immediate surroundings of a swimming pool, hot tub, pond or any vessel containing water.
- Children of less than 3 years should be kept away unless continuously supervised.
- Children aged from 3 years and less than 8 years shall only switch on/off the appliance after it has been placed or installed in its intended normal operating position. Additionally, they shall have been given supervision or instruction concerning use of the appliance in a safe way, and understand the hazards involved.
- Children aged from 3 years and less than 8 years shall not plug in, regulate and clean the appliance or perform user maintenance.
- Ensure any person operating the heater has the capability to do so without risking injury to themselves or others. Do not use this heater with a programmer, timer, separate remote-control system or any other device that switches the heater on automatically, since a fire risk exists if the heater is covered or positioned incorrectly.
- Do not move the unit when in use. Wait until the heater is completely cool before moving and check that it has been unplugged from the electrical socket.
- Never connect this appliance using a multi-way socket extender, plug expander or travel plug adaptor, etc.
- Never jolt or drop this appliance: doing so can cause glass heat bulb(s) to crack and fail violently.

### POSITIONING THE APPLIANCE

- This appliance is designed and intended for outdoor use only.
- This appliance contains hot and arcing components inside. Do not use in areas where petrol, paint, explosive and/or flammable liquids are used or stored.
- This appliance must NOT be located:
  - immediately below an electrical socket outlet;
  - within close proximity (1m) of any combustible materials e.g. furniture, trees, leaves, dry grass and bushes, etc;
  - with the heating element facing upwards;
  - where the cable could cause a trip hazard.
- This appliance must be located at least 1.8m from the ground, and:
  - at least 0.25m away from a ceiling, or overhanging joists, etc;
  - suspended in a stable orientation using the support linkage provided, according to the Assembly Instructions.
- This appliance must be switched off and allowed to cool before moving, repositioning or changing the orientation.

### ELECTRICAL EXTENSION LEADS

- If it is necessary to use an extension lead to connect this appliance, be sure that it meets the following specification:
  - Tested and manufactured to BS 1363-2, or equivalent national Standards for electrical plug/sockets
  - Rated at 13A, 240 Volts, 3kW or higher
  - IP rated to IP54 or higher
  - Single socket extender only
- To protect against electric shock, it is recommended to connect a Residual Current Device (RCD) between the extension cable's plug and the wall mains socket.
- Ensure that the extension lead is fully unwound from its cable tidy or reel, before connecting any heating appliance.
- Never connect more than one extension lead in line with a heating appliance.
- Never use an extension lead in wet conditions, in rain or whilst using a hose pipe.

### MAINTENANCE & STORAGE

- Switch off then unplug this appliance before cleaning.
- Clean only with a soft damp cloth, and mild detergent if necessary; allow to dry naturally before re-connecting the mains plug. Do not use any abrasive substance or cloth for cleaning as this could damage the surface of the appliance.
- Avoid touching the heating element as finger marks will cause its premature failure. Any inadvertent finger marks should be wiped off using a soft cloth and methylated spirit or isopropyl alcohol.
- This appliance contains no user-replaceable parts. Seek the services of a certified electrician to replace the bulb/element if necessary.
- Do not leave this appliance outdoors overnight or when not in use. Store in a clean, dry environment free from moisture and above 0°C.

### DISPOSAL



This symbol means that used electrical and electronic equipment (WEEE) should not be mixed with general household waste. For proper treatment, recovery and recycling, please take this product(s) to designated collection points where it will be accepted free of charge. Please contact your local authority for further details of your nearest designated collection point.

---

## Parts List

1 (1x)

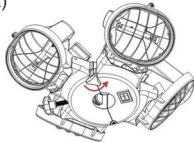

2 (4x)



A (4x)



Prior to assembly, read the instructions carefully. Check all parts against this parts list. Carry out assembly on a soft surface to avoid scratching the paint. Please retain this information for future reference.

---

## Assembly Diagrams

Figure 1

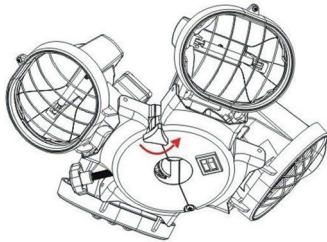

Figure 2

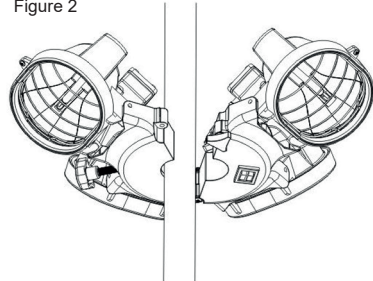

Figure 3

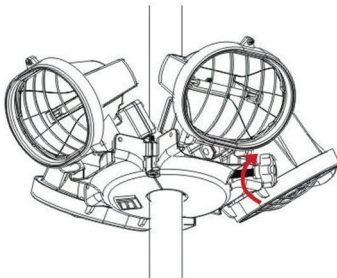
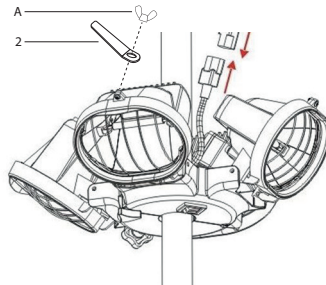

Figure 4



---

## Assembly Instructions

**IMPORTANT!** - Remove any packaging before use, but retain the safety instructions and store them with this product.

- STEP 1 - Ensure parasol is secure and stable by using a suitable parasol base.
- STEP 2 - Remove the vertical thumbscrew as shown in figure 1 of the assembly diagram.
- STEP 3 - Open unit and attach around the parasol pole. Re-insert vertical thumbscrew and tighten fully as shown in figure 2 of the assembly diagram (do not overtighten).
- STEP 4 - Slide the unit up the parasol pole to the desired height (no less than 1.8m) and tighten the large horizontal clamping thumbscrew (figure 3).
- STEP 5 - Bring the mains lead through the hole and connect into the base of the unit.
- STEP 6 - Connect plug on the mains lead into an RCD protected outdoor weatherproof socket.
- STEP 7 - To tilt heater heads, attach the adjusting lever (2) to each heater head using 1x wing nut (A).

The product is now ready to use but please ensure you have read these instructions thoroughly prior to use.

---

## Operating The Appliance

Connect the power cable to a permanent, 13-amp, supply located in a safe, dry area. If absolutely necessary, only use an extension lead that meets the requirements stated in the Care and safe use guidelines.

- Press the right switch down (icon 'I') to turn on the right side elements for 900w heat.
- Press the left switch down (icon 'I') to turn on the left side elements for 900w heat.
- To turn on all elements, press both switches down to give 1800w heat.
- To turn off the heaters, press the switches up (icon 'O').